

产品特性/Product Features



- IP66/IP67/IP68/IP69K
- 150A 85°C长时间载流能力
- 12-750VDC
- 1000M Ω (1000VDC) , IEC 60664-1
- PWM

主要性能参数/Main Performance Parameters

| | | | |
|----------|----|------------------------------|------------------------------|
| | | 1a | |
| | | $\leq 0.5\text{m}$ (at 150A) | |
| | | 150A | |
| | | 2×10^5 | |
| | | 450V型 | 750V型 |
| | | 750VDC | 750VDC |
| | | 1500A(320VDC)1 | 1500A(320VDC)1 |
| | | 67.5kW | 112.5kW |
| 1) | | 5×10^3 450VDC, 150A | 1×10^3 750VDC, 150A |
| | | 500 450VDC, -150A | 500 750VDC, -150A |
| | | 1 320VDC, 1000A | 1 320VDC, 1000A |
| 2) | | 150A: | |
| | | 200A:10min | |
| | | 300A:1min | |
| | | 1000A:1s | |
| 辅助 接点 | Ue | 1NO | |
| | | 30VDC/125VAC | |
| | | 2A DC /3A AC | |
| | | 9V0.1A | |

1) $U_e \leq 600\text{V}$ 23°C, $t_{on} \leq 0.6\text{s}$; $t_{off} \leq 5.4\text{s}$.

2) $U_e \leq 600\text{V}$ 85°C, $S_{on} \leq 50\text{mm}^2$, $t_{on} \leq 0.6\text{s}$; $t_{off} \leq 5.4\text{s}$.





Mounting hole size

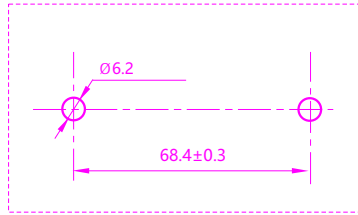

Wiring diagram

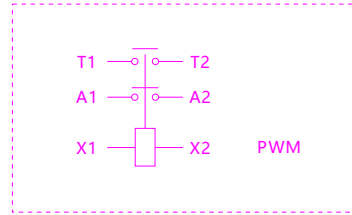

Electrical life curve

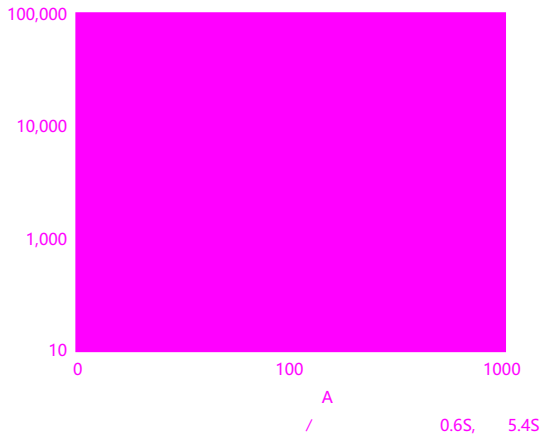

Tolerance curve

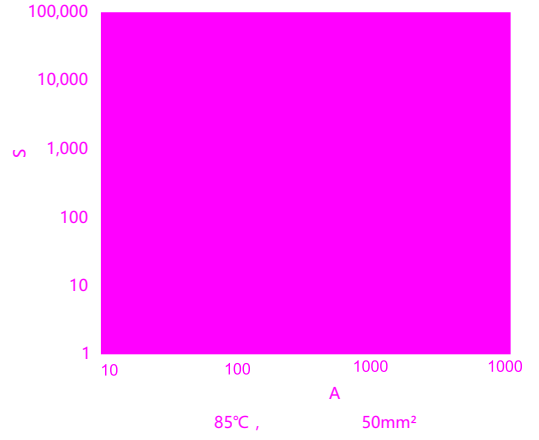

1

| | | | | | |
|----------|-------------|-----------|-----|------|-----------|
| M5螺钉 内螺纹 | 3N-m 4N-m | Ø5.0-Ø5.5 | 3mm | M5螺钉 | 3N-m~4N-m |
| M8 | 10N-m~12N-m | Ø8.0-Ø8.5 | 3mm | | |

2 50m
3 3mm

声明/Statement:

